



युनाइटेड इंडिया इन्श्यूरेन्स कं. लि.
UNITED INDIA INSURANCE CO LTD

[A Government of India Enterprise]
Registered & Head Office, United India House
24, Whites Road, Chennai – 600 014

**TENDER FOR PROPOSED INTERIOR FURNISHING, CIVIL, ELECTRICAL
& HVAC WORKS OF THEIR TP CELL AT 1ST FLOOR, KRISHNA
COMPLEX, NEAR GHADI CHOWK, JAIL ROAD, RAIPUR (C.G.)**

Volume - B
[Financial Bid]

Employer

United India Insurance Co Ltd
Head Office, United India House
24, Whites Road
Chennai – 600 014
Ph: 044- 28 575 421/282/281

Consultant

M/s NICON INDIA
Architects, Engineers, Planners
34, Gurukul Complex, Kalibadi
Road, Raipur (C.G.) 492001
Ph: 98271-58700, 98263-23237



UNITED INDIA INSURANCE COMPANY LIMITED

Regional Office Raipur

647A, 648, 649, 6th Floor, Magneto Offizo, Magneto The Mall, Labhandi, Raipur-492010

Phone No. 0771-2259373 Fax No. 0771-2259378

**Interior Furnishing, Electrical and related works of United India Insurance Co. Ltd. DO,
TP Cell at 1st Floor, Krishna Complex, Near Ghadi Chowk, Jail Road, Raipur**

ABSTRACT OF SECTION III

ITEM	AMOUNT
PART – A	
1. Interiors and furnishing works	Rs.
2. False Ceiling works	Rs.
3. Electrical Works	Rs.
Total	Rs

In words

GST @ of 18% on the final value

Place:

Seal & Signature of tenderer

Date:

SECTION - II

TECHNICAL SPECIFICATION

A. Introduction to Technical Information Section

Various works are to be done for the interior work in the different Branches of United India Insurance Co. Ltd. by supplying / installing / fixing in position as per the approved plan / design and as per the details and specification under strict & successful implementation of all the terms, condition, limitations and binding laid down in the tender documents. The work includes fabrication of aluminum partition, furniture miscellaneous electrical works, painting work and flooring work.

The information, instructions and details provided here after are the technical know how of the work to be done, which shall be carefully read & understood before filling up the tender and shall be implemented exactly in the same fashion they mean.

Most of the information & instructions are repeated several times to make the things clear at every point.

LIST OF MATERIALS AND THEIR APPROVED MANUFACTURES

1. Block Board Marine Grade and plywood	Green/Archid/Global Associate Conforming to IS-303 Commercial grade	Green/Century/ BWP
2. Particle Board	Eco Board, Nova pan	
3. Laminates	Green/Formica/Sunmica	
4. Locks	Godrej, Doorset, Link, Quba	
5. Hardware	Earl Bihari/Dorma/Hatelle	
6. Glazing	Asahi, Saint Gobain, Modifloat	
7. Door Closers	EarlBihari,Hardwyn, Shakti, Hyper, Amar	
8. Paints	Asian paint/ICI/Berger/Nerolac	
9. Fire Retardants	Viper	
10. Sanitary ware	Parryware, Neycer, Cera, Impolo, Tita	
11. Tiles	Johnson, Kajaria, Nitco, Western Marbo	
12. Plumbing fixtures	Marc, Jaguar, Roca, Plumber	
13. Aluminium Sections	Oel, Jindal, RR	
14. Blinds	Vista Levlor, Mac, Marvel, Track	
15. Antistatic Floor	Asian/Armstrong	
16. Ceiling	India Gypsum/Lafarge board	
17. POP Beading/Cornice	India Gypsum/Diamond	
18. Water Proofing Compound	SIKA,	
19. Steel Section	TATA, SAIL, Jindal, Goel, Nirman	
20. Adhesives	Fevicol, Vishwascol	
21. Chairs	Godrej/ Wipro/Featherlite	

APPROVED MAKE OF MATERIALS

(For Electrical works)

S. No.	Description	Make
1	PVC insulated copper wires (Multi stranded 650 V Gr.)	L & T / RR Cable / Finolex / Havells, Polycab/Anchor
2	MS Conduit and accessories	BEC / NIC / AKG
3	Coaxial TV Cable	Finolex / National
4	Telephone wire	Finolex / Delton / Anchor/ Havells
5	Aluminum Armoured XLPE / PVC cables	Havells / Finolex / CCI / Gloucester
6	MCCB / MCB / ELCB / DB	Legrand / Seimens / L & T / Hagger / Schneider / Havells/ ABB
7	Load line DB	MDS / Havells, L&T/ ABB/ Legrand
8	Ceiling fans	Crompton / Usha / Havells
9	Exhaust fan	Crompton / Havell's / GEC
10	Luminaries LED	Philips /Crompton / Wipro / Havells
11	Decorative light fittings	Philips /Crompton / Wipro / Havells / Decon
12	PVC non metallic conduits and accessories	BEC / Precision / AKG, Polycab
13	Panel Manufacturer	CPRI approved manufacturers.
14	Bulb holders, Ceiling rose, 6/16 A Switch socket /Telephone socket / TV Outlet / Fan regulators.	Anchor Roma/ Legrand / Havells/Crab tree
15	G I Pipes	Swastik / Khandelwal / Prakesh
16	Lugs / Glands	Dowells / Comet/ L&T
17	Data Cable (Cat 6e)	D- Link

Note:

All the materials to be of ISI make.

The contractor shall submit sample of the above approved material and the Consultant/ Client shall have the discretion to approve any of them.

Consultant / Client decision in this regard shall be final and binding.

In case any material is not available for any one or all the approved make the Consultant / Client shall select and approve alternative make.

INTERIOR FURNISHING, ELECTRICAL & RELATED WORKS OF UIIC LTD.

DO, LIC BUILDING, PANDRI, RAIPUR (C.G.)

1. INTERIOR FURNISHING WORKS

S.No.	Item/Description	Qty	Unit	Rate Rs.	Amount Rs.
1	<p>PARTITION WORKS:</p> <p>Partition works shall be done with following specification: Aluminum frame of section 1.5"x1.5" fixed in position with 2.5" to 3" long steel neetle fold screw. The vertical and horizontal members being placed at 2' c/c as per site condition as directed. Panel for solid partition fixing 6 mm MR Grade plyw-ood, conforming to IS:303 commercial ply of Archid ply Platinum, Green ply make on both sides of frame work with fevicol SH and headless nails of 17 nos of 1.25" length and securing the cover with 1.5" long steel nettled fold screw. Making the plywood surface level before fixing the laminate/veneer. 1 mm th laminate/ mica fixing on inside of panel with 1.5 mm th. Groove in the panel as per the design with provision of the openings in the panel for switch boards, box and cuts in frame for carrying conduits if necessary, and fixing 1.0 mm laminate on the outside face of shade and colour a per UIIC colour scheme given in the tender specification with 8mm glass to be given in the design. The open edge are to be blocked by teak wood bead of required size and design.</p>				
a	<p>Entrance Door Partition: Providing and fixing Entrance Door partition in above specification with entrance door of size (5'x7') double leaf glazed with 12 mm glass with all necessary fitting mounted on floor machine & pivot complete. i) Float glass and wooden partition (Entrance Door, CI room)</p>	430	sft		
b	<p>Low Height Partition (4' ht): Providing and fixing low height partition in above specs with laminate on both sides and top of each partition fixed with 10mm glass of 1'x2' firmly secured on SS D brackets.</p>	30	sft		
d	<p>Partition with both side laminate & glass including doors (Full height):</p>				

	<p>Providing and fixing partition in above specification with 1mm laminate on both sides as per design in color and shade of UIIC .</p> <p>The door shall be of size 3'x7' made with 32 mm MR Grade plywood conforming to IS:303 commercial ply of Archidply, Platinum, Green ply with mica pasted on both sides up to 3' ht and 6 mm glass of size 2'4"x3'8" above 3' to match the partition as directed.</p> <p>(Store, Pantry, UPS/Store Doors)</p>	600	sft		
2	<p>DOOR FIXTURES:</p> <p>Providing and fixing of door fixtures.</p> <p>a) Door handle mortise type Godrej, Door set make</p> <p>b) Door Stopper (Hyper, Amber, Shakti)</p> <p>c) Floor Machine (Hyper, Amber, Shakti)</p> <p>d) Door closure (Hyper, Amber, Shakti)</p> <p>e) SS handle 12" long (Door set, Amber, Shakti)</p>	3	nos		
3	<p>WALL PANELLING:</p> <p>Providing and fixing wall panel in column/entrance area of banking hall up to a height of 9' with 10/12 mm thick ply of Green, Archid, Platinum make conforming to IS:303 MR Grade ply fixed on wooden frame work laid grid of 2'x2' pasted with 1mm thick laminate of color/ shade as per UIIC scheme as given in tender specification.</p> <p>(Columns)</p>	200	sft		
4	<p>WORK STATIONS:</p> <p>Providing, fabricating and fixing in position in Officer's room table of size 4'3" x 2'6" x 2'6" with drawers shelves etc complete with locks, clip catchers handle as per the plan made with 18, 12, 10 mm th ply board of approved make and quality with 1.0 mm thick laminate as given in tender specification fixed on exposed faces. All inside faces to be pasted with 0.7 mm off white liner mica/ putty, painted with white paint.</p> <p>(Work stations)</p>	6	nos		
5	<p>MANAGER TABLE:</p> <p>Fabricating and fixing in position in Officer's room, table of size 5'6"x 3'0" x 2'6" with drawers etc. shelves etc. complete with locks, clip catchers as per the plan made up with 18, 12, 10mm th MR Grade ply conforming to IS:303 commercial ply with 1 mm thick laminate as given in tender specification fixed on the top and exposed face. Inside face shall be pasted with 0.7 mm off white liner mica. The table shall be provided with metal key board tray of ebco/Earl bihari make.</p>	1	nos		

6	TABLE: DEPUTY MANAGER Fabricating and fixing in position in Assistant room, table of size 4'6"x 2'3" x 2'6" with drawers etc. shelves etc. complete with locks, clip catchers as per the plan made up with 18, 12, 10mm th MR Grade ply conforming to IS:303 commercial ply with 1 mm thick laminate as given in tender specification fixed on the top and exposed face. Inside face shall be pasted with 0.7 mm off white liner mica. The table shall be provided with metal key board tray of ebco/Earl bihari make.	1	nos		
7	CABINET: Providing and fixing File cabinet of size as per drawing made of 18, 12 mm plyboard with all the necessary fixtures like handles, lock, clip catcher etc. all the exposed surface are to be pasted with mica 1.0 mm of color as given in the specification scheme. All back side shall be pasted with 0.7 mm off white mica. The back side of cabinets wherever visible shall have the same mica as that of UIIC color scheme. All ply wood shall be MR Grade conforming to IS:303				
a	Cabin storage cabinet size (1'6" deep x 3' high)	140	sft		
b	Side table credenza of size 1'6"x2'6"	15	sft		
	TOTAL			Rs.	

2. FALSE CEILING WORKS

S.No.	Item/Description	Qty	Unit	Rate Rs.	Amount Rs.
1	GYPSUM BOARD CEILING: Providing and fixing false ceiling as per approved plan with Gypsum board (India Gypsum, Lafarge) 12 mm th on frame consisting of main and cross runners of GI section of 2.5" size @ 2.85 kg/12 feet and 1.75" @ 2.9 Kg/12 feet connected with screws to form a grid of not more than 2'x2'. Opening for lights and fans to be provided. The ceiling height shall not be less than 9'6" from the floor. The rate includes all extra frame work required to hold the concealed light fixtures, jointing with compound and fibre tape 3mm gypsum punning/ plastering and 3 coats of Asian/Nerolac/ICI or equivalent Acrylic emulsion paint.	550	sft	70	38500.00
	TOTAL			Rs.	38500.00

3. ELECTRICAL WORKS

S. No.	Item/Description	Qty	Unit	Rate Rs.	Amount Rs.
	<p>Providing and fixing, testing and commissioning for point wiring two nos. 1.55 sq. mm/2.5 sq.mm or 4.0 sq. mm PVC insulated single core stranded copper conductor wire 1100 volt grade (for Ph&N) and one nos. 1.0 sq. mm/ 1.5 sq. mm PVC insulated single core stranded copper conductor wire 440 volt grade, for earth wire 1.6 mm th. 25 mm dia BEC / NIC / AKG make PVC conduit pipes. All wires are to be ISI mark approved / specified make Anchor/ Finolex / Havells complete with all drops up to boards, staples, accessories and hardware etc. Installing the conduit in slabs, wall etc. The point shall include modular type switches of MK Anchor, Roma, Crab tree make as approved / specified in required combination including electronic regulator , 6 ASP control switch 3-plate ceiling rose, angle or straight holder adequate size to mount control switches for lights, fans, call bell, sockets. Sockets for half points and ceiling fan regulator.</p> <p>a) Light / Exhaust Fan points.</p> <p>b) Fan points with regulator (ceiling fastner+ bracket) (2x1.50 sq.mm + 1x1.5 sq.mm)</p> <p>c) Call bell points inclusive of call bell. (BM Cabin)</p> <p>d) 6 Amp 3/5 pin socket half point on Switch Boards (2x1.5 sq.mm + 1x1.5 sq.mm)</p> <p>e) 16 Amp 3/5 pin socket half point for BM, Officer Table & Counters-5 nos and Switch Boards-3 nos (2x2.5 sq.mm +1x1.5 sqmm)</p> <p>f) On/Off starter 25/32 A for AC modular Havell's make.</p>	25	nos		
		1	nos		
		1	nos		
		4	nos		
		4	nos		
		4	nos		
2	TELEPHONE POINT:				
	a) Supplying, fixing and testing of telephone socket point wiring with two line telephone wire of approved Anchor/Havells/Finolex make in 1.6 mm th 1" dia PVC conduit pipe including double line tel-Jack (modular type) on the switch board.	4	nos		
	b) Supply and installation of two pair telephone cable in PVC pipe of approved make.	40	m		

3	CEILING FAN:				
	Supplying ,erecting and testing of approved/specified make Crompton, Havel, Orient electric ceiling fans complete with down rod, canopy, blades and speed regulator 230-250 volts including connection with all necessary materials as required.	1	nos		
4	WALL FAN:				
	Supplying, erecting and testing of approved / specified Havells, Orient or Crompton make oscillating cabin fan complete with base, blades, gaurds, speed regulators etc. 230-250 volts with connections, raw bolts/anchor hole fastener completely finished as required.	7	nos		
5	LIGHT FIXTURES:				
	Supplying, fixing and testing of approved Phillips Havells, Wipro, Crompton, Syska or its equiv light fittings complete in all respect				
	1. Recessed mounting LED Panel 35 w Phillips, Crompton, Wipro or its equiv 24"x24"	9	Nos		
	2. Recessed mounting LED Down Light 12w make Phillips, Wipro, Crompton, Syska or its equiv	2	Nos		
	3. Supply and installation LED Batten Light 18w make Phillips, Wipro, Crompton, Syska or its equiv	2	Nos		
6	CIRCUIT WIRING:				
	Supply and installation of circuit in app. make 1.6 mm thick, 25mm dia PVC pipes and at places where decorum is to be maintained in PVC casings with approved make PVC insulated multi strand copper wire as under The rate shall be inclusive of all necessary fittings like junction boxes, tees, bends, saddles screws etc complete. PVC pipe to be of BEC/NIC/AKG make and wire of Havells, Anchor, Finolex make.				
	a) 4x2.5 sq.mm+2x1.5 sq.mm for Computer UPS supply	60	mts		
	b) 2x2.5 sq.mm + 1x1.5 sq.mm for Lighting Boards	50	mts		
	c) 2x4 sq.mm + 1x2.5 sq.mm for AC power supply	40	mts		
	d) 4x10 sq.mm + 1x6.0 sq.mm for Main Panel / UPS	10	mts		
	e) 4x16 sq.mm + 1x10.0 sq.mm for AC from supply.	15	mts		

7	COMPUTER UPS POINT:				
	Supply and installation and connection of modular type app./ specified switch and socket complete with PVC box plate screws and all other accessories.				
	a) 2 Nos. socket + 2 Nos. switches (6A)	9	nos		
	b) 1 Nos. socket + 1 Nos. switch (6/16A)	9	nos		
8	MAIN PANEL:				
	Supply, installation, testing and commissioning of the following items on the main panel:				
	1) 63 amps cut outs 3 nos. on the panel.	3	nos		
	2) Main switch with HRC fuses, 63 amps. Crompton Greaves or Havel's make.	1	nos		
	3) MCB DB having incomer 1 nos.100 amps TPN Isolator and 2 nos. 32 amps TPN MCB outgoing. (Havel's/MDS make factory fabricated).	1	nos		
	4) TPN MCB 63 amps, 415 V with enclosure (Havel's/ MDS make)	1	nos		
	5) MCB DB having incomer 1 nos. 40 A DP MCB and 10 nos. 10/6 A.S.P. MCB (Havel's/MDS make factory fabricated)	1	nos		
	6) 3 phase indicator lamp with gang box.	1	nos		
9	Supply, installation, testing and commissioning of distribution board incoming 63 TPN MCB - 1 Nos.outgoing 6 Amp SPMCB - 8 Nos. and 2 Nos. 40 Amp DPMCB.	1	nos		
10	MAIN POWER CABLE:				
	Supply and installation of 4 x 25 sq.mm Aluminium armoured cable with accessories required for its fitting in position, for power supply from CSEB pole and DG set. Cable should be of CCI/GLOSTER/FINOLEX make	10	mtr		
11	DATA CABLING FOR COMPUTERS:				
	a) Providing, supplying and laying of new D-Link concealed/open data line Cat 6e in separate ISI pvc casing capping (as and where required) for the location of computer terminals, inclusive of testing and commissioning, certification etc. complete.	150	mtr		

	b) Supplying and installation of jack type computer socket Link make RJ-45, complete with female unit on counters/side table/ walls along with other electrical output. c) Providing and fixing i) D-link Patch cord Cat6 2 metre B/Y Color ii) D-link Patch cord Cat6 1 metre B/Y Color	9	nos		
		8	nos		
		8	nos		
TOTAL		Rs.			

TOTAL (1+2+3)

Rs.

GST @ 18% of the value

Rs.

Total

Rs.

(In words)

Date:

Seal & Signature of tenderer

Place:

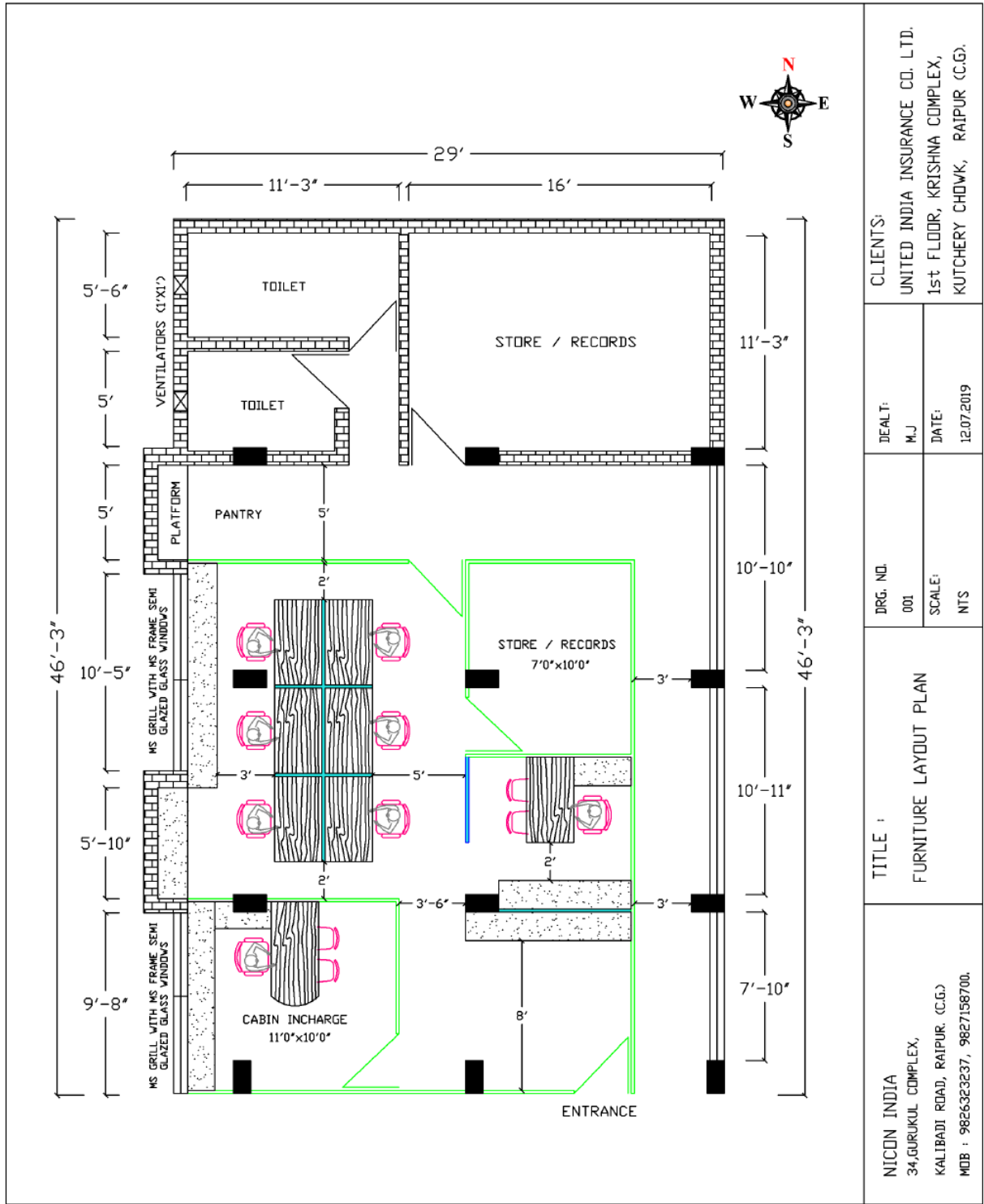

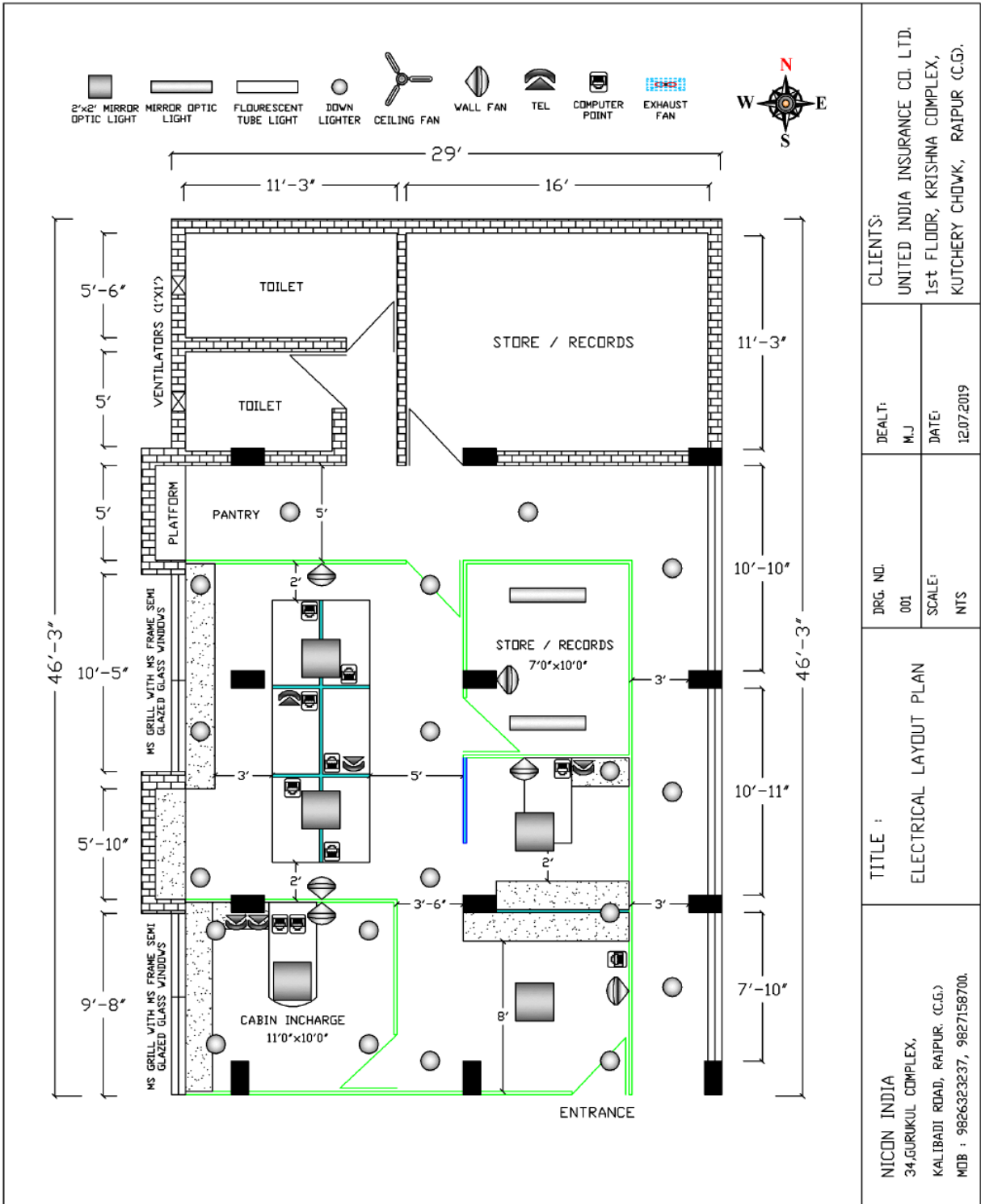

CLIENTS:	UNITED INDIA INSURANCE CO. LTD.	
	1st FLOOR, KRISHNA COMPLEX, KUTCHERY CHOWK, RAIPUR (C.G.)	
DRG. NO.	DEALT:	DATE:
001	M.J	12/07/2019
SCALE:	NTS	
	TITLE :	
ELECTRICAL LAYOUT PLAN		
NICON INDIA 34,GURUKUL COMPLEX, KALIBADI ROAD, RAIPUR, (C.G.) MOB : 9826323237, 9827158700.		